

## Suspended Perpendicular

This method of installation is used when the stationary curtain is to be suspended perpendicular to the existing ceiling structure. This option can be used for **level** or **sloped** ceiling structure. The method uses beam clamps to attach threaded rod to the perpendicular structure. The Unistrut and stationary curtain are then mounted to the threaded rods.

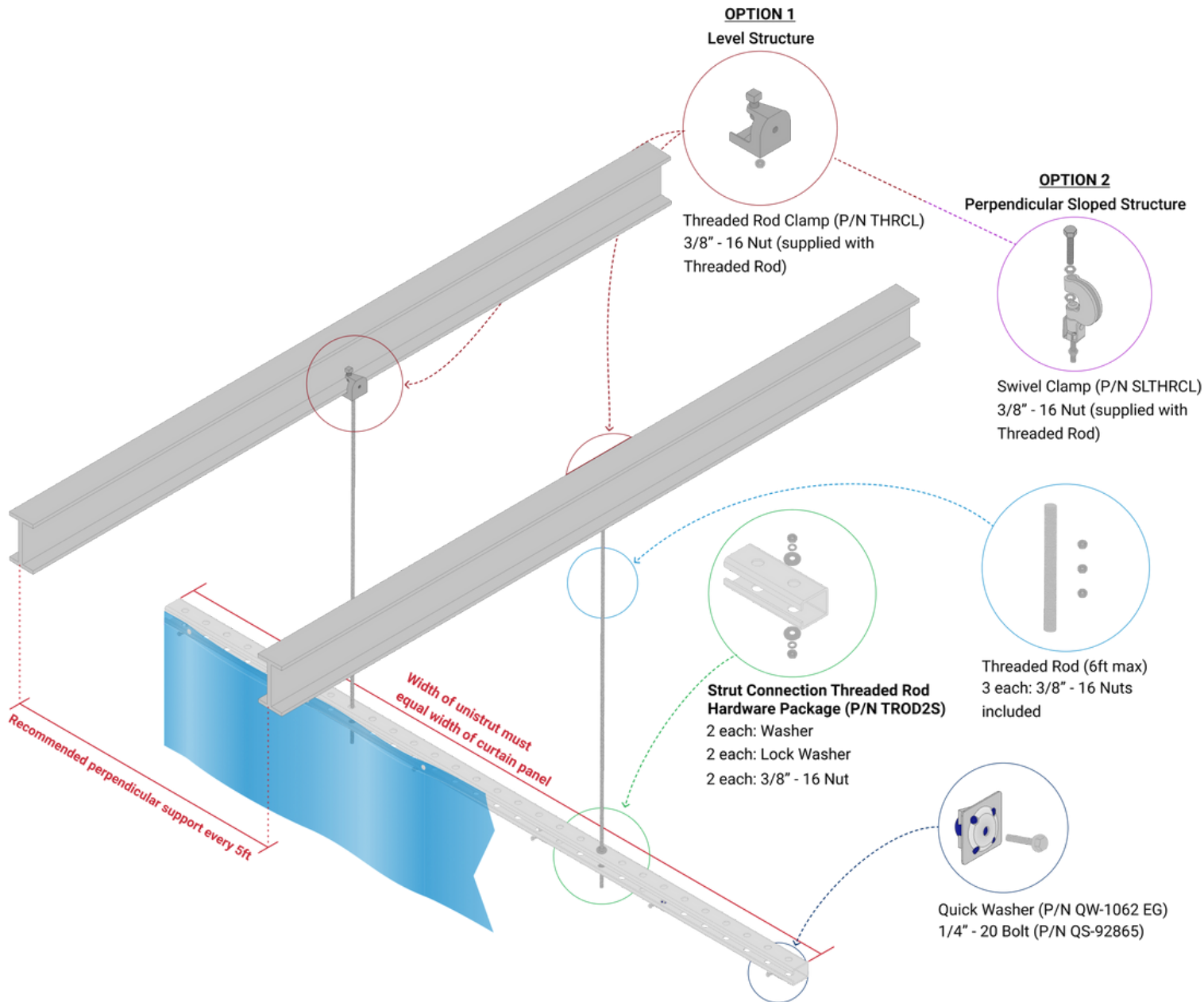

### STEP 1 - Make sure you received all the parts you ordered

- Compare the parts that you received with the packing list.
- To visually identify the parts listed on your packing list, please consult the components list found in these installation instructions spanning the last three pages.

## Suspended Perpendicular to the existing structure

**STEP 2** - Attach the threaded rod beam clamps to the **leveled** or **sloped** supporting beam. For sloped beams use the swivel clamp.

Attaching to leveled beams

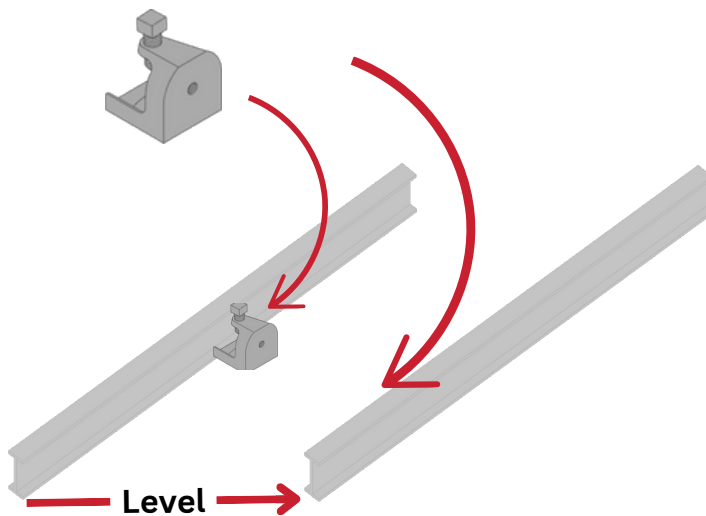

Attaching to sloped beams

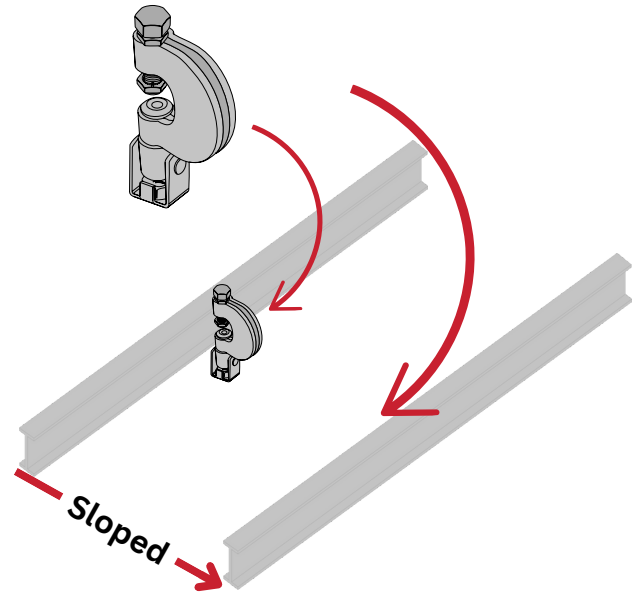

If your support beams are **leveled** use the **threaded rod beam clamp** (THRCL).

If your support beams are **sloped** use the **swivel clamp** (SLTHRC).

Attach the beam clamps to the perpendicular support beams in the ceiling along the curtain run, placing the clamps **so they face each other** (see Recommended Clamp Install Illustration above). The Unistrut should be supported every 5 feet.

**STEP 3** - A good time to check the height!

**Important:** The **top** of the Unistrut that **the curtain gets mounted to** **must** be installed at **\_\_\_\_\_ ft. \_\_\_\_\_ in. off of the floor.**

This dimension is also located atop your quotation. There will be a 1" gap between the bottom edge of the curtain and the floor. A floor sweep will cover the open space at the bottom of the curtain if it is included in your purchase.

## Suspended Perpendicular to the existing structure

### STEP 4 - If necessary, cut the threaded rod to the **correct** length

Please ensure that the threaded rods are cut to the **necessary length**, taking into consideration the **correct** height of the Unistrut to which the curtains will be attached. Verify that the threaded rod is long enough to pass through the Unistrut with extra length to accommodate the bolt assembly. **If no cutting is necessary, please do not cut the threaded rod.**

### STEP 5 - Attach the top end of the threaded rod to the clamps

#### STEP 5a - For **leveled** beams: Attach the threaded rods to the threaded rod beam clamps.

Thread 1 hex nut into the top end of the threaded rod (about 1" down) and thread the threaded rod into the beam clamp bottom hole, tighten the nut against the bottom of the clamp.

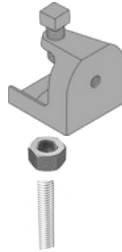

Threaded Rod Clamp (P/N: THRCL)  
3/8" -16 Nut supplied with the  
Threaded Rod

#### STEP 5b - For **sloped** beams: Attach the threaded rods to a swivel clamps.

Thread 1 hex nut about 1" down on the threaded rod top end and screw the top end into the bottom of the swivel clamp. Now tighten the nut against the bottom of the swivel clamp to secure the connection.

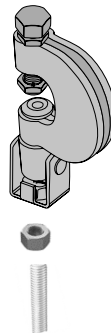

Swivel Clamp (P/N: SLTHRCL)  
3/8" -16 Nut supplied with the  
Threaded Rod

### STEP 6 - Attach the **perpendicular** Unistrut run to the threaded rods bottom ends.

**Important strut position:** Make sure the open side of the strut is facing sideways, **not** up or down, and outward. This is the side the curtain will get attached to. The front side of the curtain always faces outward.

The assembled width of the Unistrut (S-1000H3) in the parallel run **must** be equal to the width of the curtain.

The open side of the Unistrut must face to the front side, this is the side the curtain will be hung to.

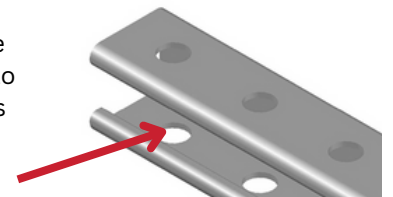

## Suspended Perpendicular to the existing structure

Starting at one side, mount the Unistrut to the threaded rods. Thread a nut, lock washer, and flat washer 2" up onto the bottom of the threaded rod, then insert the rod through the Unistrut. Use the second nut, lock washer, and flat washer to tighten the connection. **At this point make sure the top of the Unistrut is at the correct height.** Continue this process for each suspended rod. If required cut the last Unistrut to size.

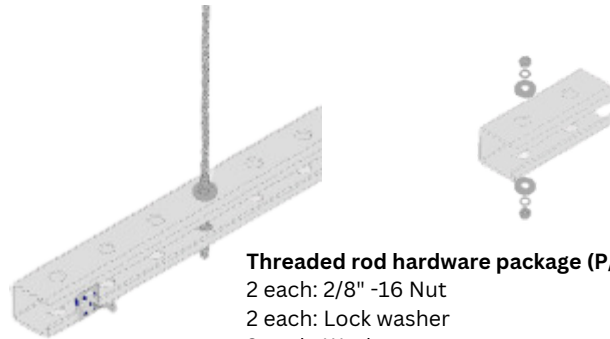

**Threaded rod hardware package (P/N TROD2S)**  
2 each: 2/8" -16 Nut  
2 each: Lock washer  
2 each: Washer  
Please note: 2 packages are required per rod connection

### STEP 7 - Connect the **perpendicular** Unistrut to each other.

The Unistrut sections can be connected either as soon as you have two Unistruts hung up, or in the end ones all the Unistrut are hung. At each Unistrut joint use either a **straight plate connector (S-1067)** or a **Heavy duty Connector (S-1377 EG)**. Four bolts and washers are provided for each connection.

Depending on the overall weight of your curtain assembly, you will receive either the connector or the connecting plate.

#### Unistrut connecting plate

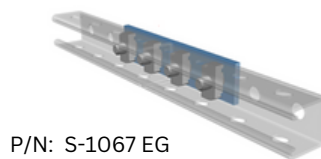

P/N: S-1067 EG

#### Unistrut connector

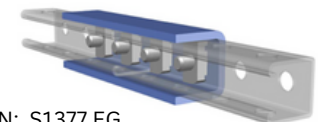

P/N: S1377 EG

### STEP 8 - Attach the curtain to the **perpendicular** Unistrut run.

The curtain gets attached using **Quick Washers (QW-1062EG)** and a **Bolt (QS-92865)**. You have the option to load the Quick Washers into the channel from either the side or the front. Most customers prefer loading the quick washers from the front and twisting them 90° (as indicated by the arrows on the QW) to ensure stability. Once in this position, they can easily be moved sideways within the channel to align with the grommet positions on your curtain. To begin, line a vertical edge of the curtain with one end of the Unistrut. **Make sure the front side** of the curtain faces the outside of the enclosure. Insert a bolt through the grommet on the top edge of the curtain and thread it into the Quick Washer. Repeat this step for each grommet along the top of the curtain.

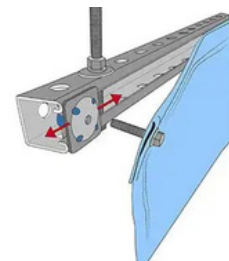

### STEP 9 - **Important:** Secure all hardware connections by tightening all the nuts and bolts. **This ensures a safe installation.**

**1" Threaded Rod Clamp**

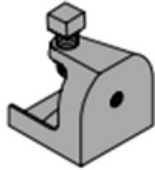

P/N: THRCL

Quantity: \_\_\_\_\_

**Side Bolt 3/8" - 16,  
3/4" long**



P/N: BLT

Quantity: \_\_\_\_\_

**1/2" Beam Clamp**



P/N: BC-6H375

Quantity: \_\_\_\_\_

**Unistrut holes on 3 sides**

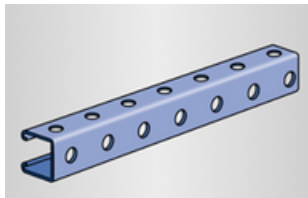

P/N: S-10003-length  
Available 2' to 10'  
9/16" dia.holes  
1.7/8" on center

Quantity: \_\_\_\_\_

**U-Bolt**

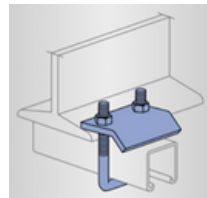

P/N: S2785  
incl. 2 nuts

Quantity: \_\_\_\_\_

**Quick Washer  
1/4" x - 20 thread hole**

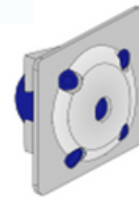

P/N: QW-1062 EG

Quantity: \_\_\_\_\_

**Side Bolt 1/4" - 20,  
1.25" long**



P/N: QS-92865

Quantity: \_\_\_\_\_

**3/8" - 16 Threaded Rod  
Incl. 3 ea. Nuts**



P/N: THR Length  
Available in 2', 3', 4', 6'

Quantity: \_\_\_\_\_

**Threaded Rod  
Side Plate**

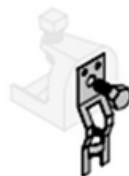

P/N: STHRMP

Quantity: \_\_\_\_\_

**11/16" Swivel Clamp**



P/N: SLTHRCL

Quantity: \_\_\_\_\_

**Strut to strut connection  
Hardware package**

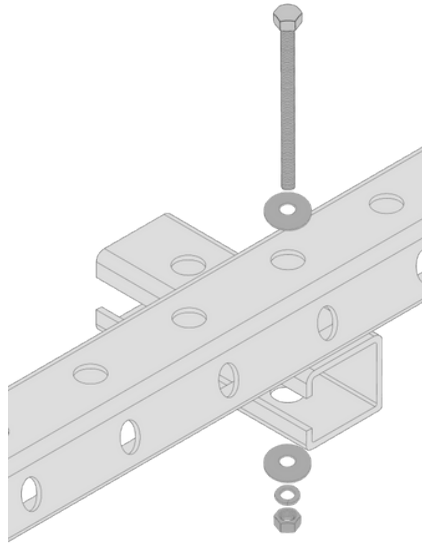

P/N: S2S Includes: 1 each Bolt 3/8" - 16, 4" long  
2 each washers  
1 each lock washer  
1 each nut 3/8" - 16

Quantity: \_\_\_\_\_

**Strut connection to Threaded Rod  
Hardware package**

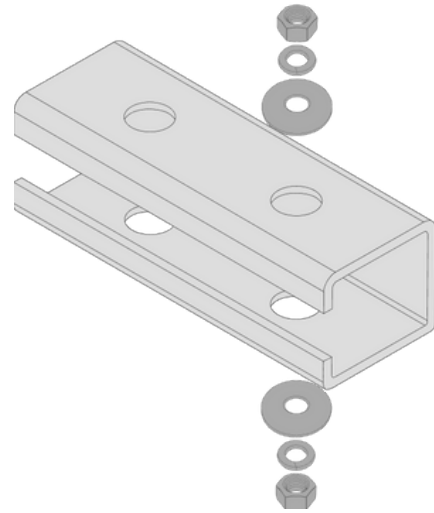

P/N: TROD2S Includes: 1 each washer  
1 each lock washer  
1 each nut 3/8" - 16

Quantity: \_\_\_\_\_

**Threaded Rod to Truss**

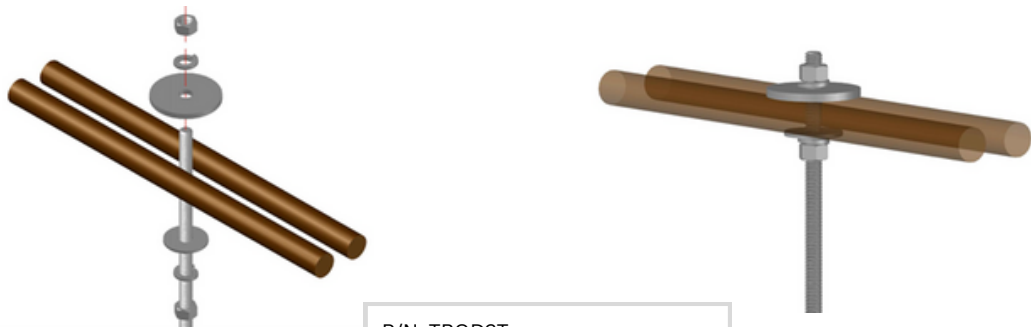

P/N: TROD2T  
Includes: 1 each big flange washer  
1 each regular washer  
2 each lock washers  
2 each 3/4" - 16 nuts

Quantity: \_\_\_\_\_



**Unistrut connector**

4 X

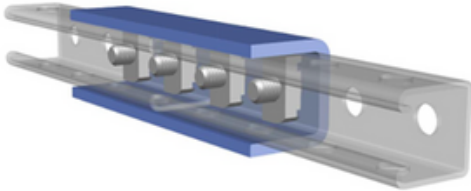

4 X

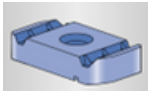

P/N: S1377 EG Includes : 4 each Bolt 1/2" - 13, 1.25" long  
4 each threaded nuts

Quantity: \_\_\_\_\_

**Unistrut connecting plate**

4 X

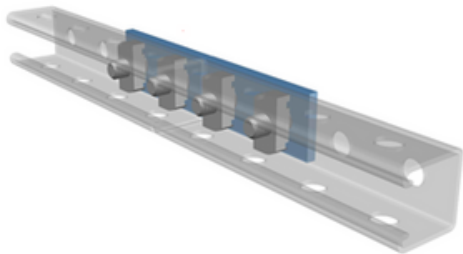

4 X

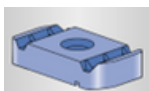

P/N: S-1067 EG Includes : 4 each Bolt 1/2" - 13, 1.25" long  
4 each threaded nuts

Quantity: \_\_\_\_\_

**Curtain/Panels**

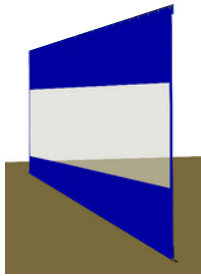

Quantity: \_\_\_\_\_

**Valance**



Velcro attaches to the side of the track

Quantity: \_\_\_\_\_

**Chain Weighted Bottom**

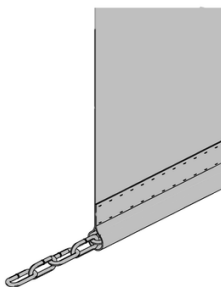

Sewn into the hem

Quantity: \_\_\_\_\_

**Floor Sweep**



Velcro attached to the bottom hem

Quantity: \_\_\_\_\_

**Wall Attachment Strip**



Wall attachment strip

Quantity: \_\_\_\_\_

**D-Ring**



D-Ring with Carabiner

Quantity: \_\_\_\_\_

**Adhesive Velcro**



Color - Black or White  
1" or 2" wide

Quantity: \_\_\_\_\_

**6" Wide Vinyl Tape**



Color - Royal Blue, Gray, Black, or White. Comes on a roll or 4' long strips

Quantity: \_\_\_\_\_